

June 26, 2008

G. Jeffrey Hu  
Water Resources Control Engineer  
California Regional Water Quality Control Board, Site Cleanup Unit IV  
Los Angeles Region  
320 West 4<sup>th</sup> Street, Suite 200  
Los Angeles, CA 90013

***Addendum to Revised Holifield Park Supplemental Investigation and Groundwater Remediation Work Plan, Defense Fuel Support Point Norwalk, 15306 Norwalk Boulevard, Norwalk, California (SCP No. 0286A, Site No. 16638)***

Dear Mr. Hu:

Parsons on behalf of the Defense Energy Support Center (DESC) is pleased to submit this addendum to the revised Holifield Park work plan<sup>1</sup> submitted in April 2008 for the DESC Norwalk Site. The April 2008, revised workplan was approved by the California Regional Water Quality Control Board, in a letter dated June 11, 2008. This addendum further details the strategic approach for the remediation of groundwater beneath the park and discusses the proposed changes to the April 2008 work plan.

The work plan submitted in April 2008 proposed the installation of two groundwater extraction wells (designated GW-16 and GW-17) located in the north-western area of the park. The following discussion details the proposed change to the April 2008 work plan and provides rationale for the change and proposes an alternate scope of work.

- Proposed Change: Parsons recommends that the proposed groundwater extraction wells (GW-16 and GW-17) not be installed in the park. After further strategic planning and data review, it was concluded that installing and operating these new

---

<sup>1</sup> Parsons, *Revised Holifield Park Supplemental Investigation and Groundwater Remediation Work Plan, Defense Fuel Support Point Norwalk, 15306 Norwalk Boulevard, Norwalk, California*, April 22, 2008.

wells from the park would carry the potential of drawing the on-site plume further into the park, and therefore further damaging groundwater quality. Selection of new groundwater wells will have to take into account full containment of on-site plume(s) within the site boundaries, and if practically feasible pull any potential off-site impact back towards the site.

- Proposed Alternate Scope of Work: If needed, additional groundwater extraction wells within the site boundaries along the fence adjacent to the park will be installed. Initially, existing monitoring wells, GMW-60 and GMW-61, will be retrofitted for groundwater extraction and piped to the treatment system (Attachment 1). These locations will fulfill the requirements stated above and will provide an appropriate hydraulic barrier, which will consequently have the potential of containing and “recovering” the plume on-site. The wells will be equipped with extraction pumps, wired electrically for automated and manual controls, piped to the groundwater treatment system, and programmed into the PLC. Once extraction begins from these two wells, these wells in addition to existing extraction well GW-15 will be operated on a continuous basis. After three months of continuous operation, groundwater chemistry will be evaluated from existing onsite wells and GMW-62 located in the park (and at any new wells installed in the park). Groundwater quality will be compared to historical to determine effectiveness of groundwater extraction in this area and to determine if additional onsite extraction wells are required in order to contain the plume within site boundaries. Additional extraction wells will be installed within the site if needed.

In addition, this addendum requests the extension of the reporting date from the currently approved August 11, 2008 due date to a later date. The reason for this request is based on the change of the contract term between DESC and Parsons, which has resulted in the expiration of the old contract by June 30, 2008, and the start of new contract beginning on July 1, 2008. This contract change will require us to have time to setup the new contract into the system before we actually begin the execution of the project level

# PARSONS

---

Parsons Infrastructure & Technology Group Inc.

100 W. Walnut Street • Pasadena, California 91124 • (626) 440-4000 • [www.parsons.com](http://www.parsons.com)

planned activities. The change in the strategic approach as detailed in this addendum letter would also require some time to implement than originally proposed in April.

If you have any questions please call me at (602) 852-9110.

Sincerely,



Redwan Hassan  
Project Manager

Attachment: Well Location Map

cc: File

Mr. Kola Olowu, DESC - Fort Belvoir, VA

Congresswomen Grace Napolitano,

1609 Longworth Building, Washington, D.C. 20515

Ms. Shiow-Whei Chou, Geomatrix, [SWChou@geomatrix.com](mailto:SWChou@geomatrix.com)

Mr. Edward Garcia, City Manager, City of Norwalk,

12700 Norwalk Blvd., Norwalk CA 90651

Ms. Conesa Lee, Air Force Real Property, Northrop Grumman,

1700 N. Moore, Suite 2300, Arlington, VA 22209-2809

Ms. Mary Jane McIntosh, [maryjanemc13@aol.com](mailto:maryjanemc13@aol.com)

Mr. Steve Osborn, Kinder Morgan, [OsbornS@kindermorgan.com](mailto:OsbornS@kindermorgan.com)

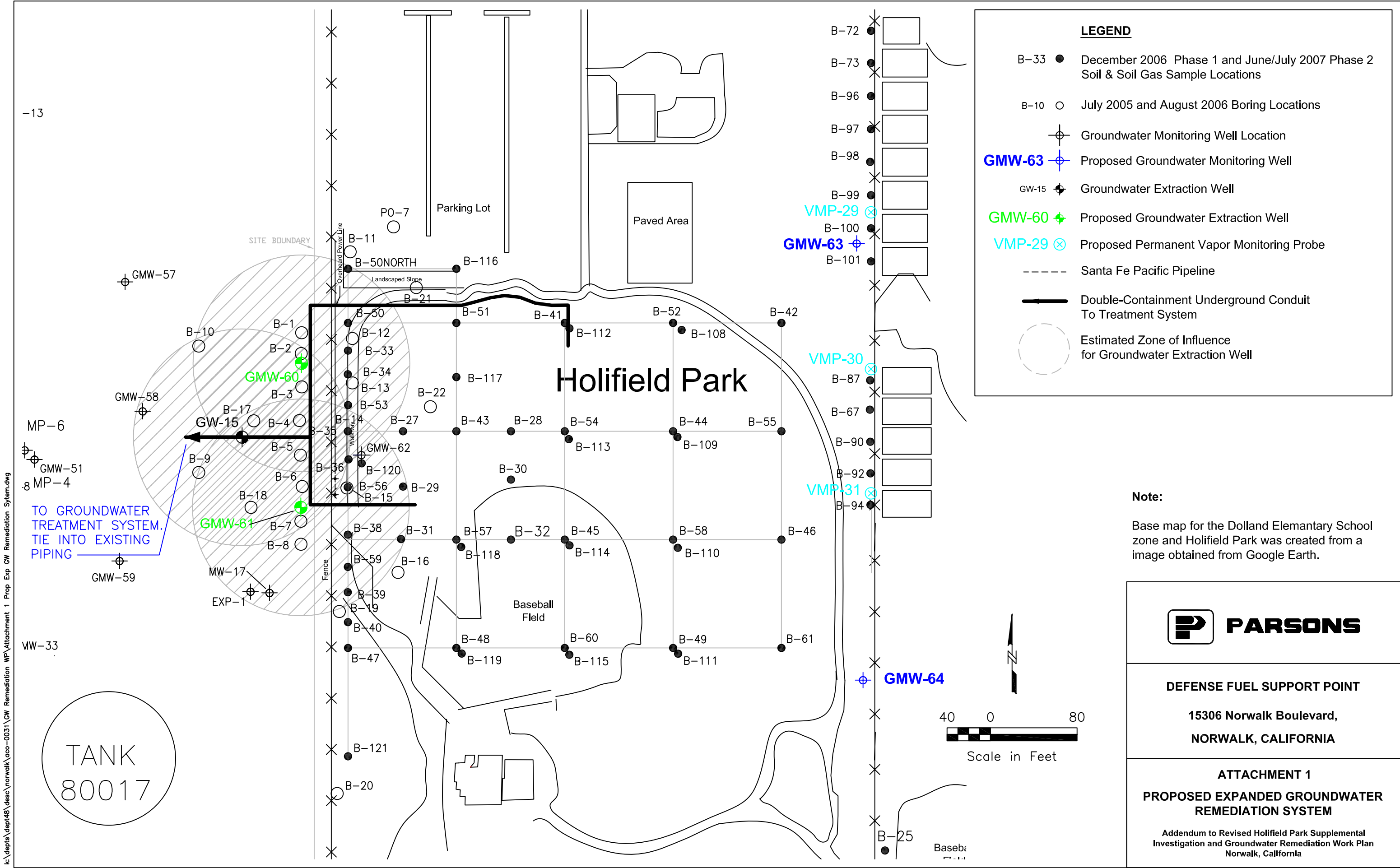

**LEGEND**

- B-33 ● December 2006 Phase 1 and June/July 2007 Phase 2 Soil & Soil Gas Sample Locations
- B-10 ○ July 2005 and August 2006 Boring Locations
- ⊕ Groundwater Monitoring Well Location
- GMW-63 ⊕ Proposed Groundwater Monitoring Well
- GW-15 ⊕ Groundwater Extraction Well
- GMW-60 ⊕ Proposed Groundwater Extraction Well
- VMP-29 ⊗ Proposed Permanent Vapor Monitoring Probe
- Santa Fe Pacific Pipeline
- Double-Containment Underground Conduit To Treatment System
- Estimated Zone of Influence for Groundwater Extraction Well

**Note:**  
 Base map for the Dolland Elementary School zone and Holifield Park was created from a image obtained from Google Earth.



**DEFENSE FUEL SUPPORT POINT**  
 15306 Norwalk Boulevard,  
 NORWALK, CALIFORNIA

**ATTACHMENT 1**  
**PROPOSED EXPANDED GROUNDWATER REMEDIATION SYSTEM**

Addendum to Revised Holifield Park Supplemental Investigation and Groundwater Remediation Work Plan Norwalk, California

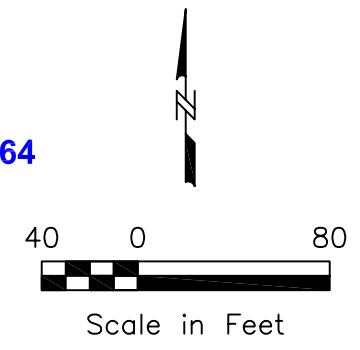

k:\depts\dept48\desc\norwalk\aco-0031\GW Remediation WP\Attachment 1 Prop Exp GW Remediation System.dwg